

RECOMMENDED MAX VEHICLE WEIGHT: 2,000 LBS (4g LOADING)
 RECOMMENDED MAX POWER: 600hp

CUSTOM DRIVE AXLES AVAILABLE

LATEST REVISION						
FUNC ID	REV	ECN	DESCRIPTION	BY	APPROV	DATE
	XXX	XXX	XXX	XXX	XXX	XXX

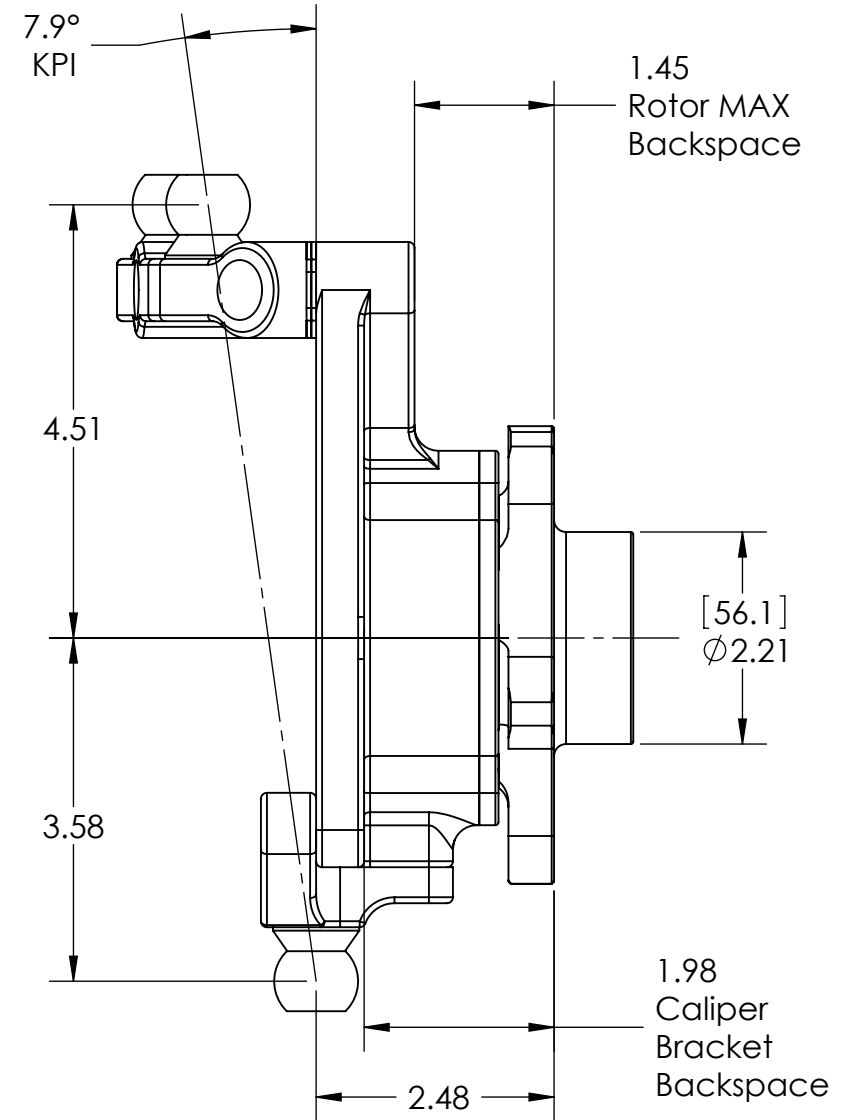
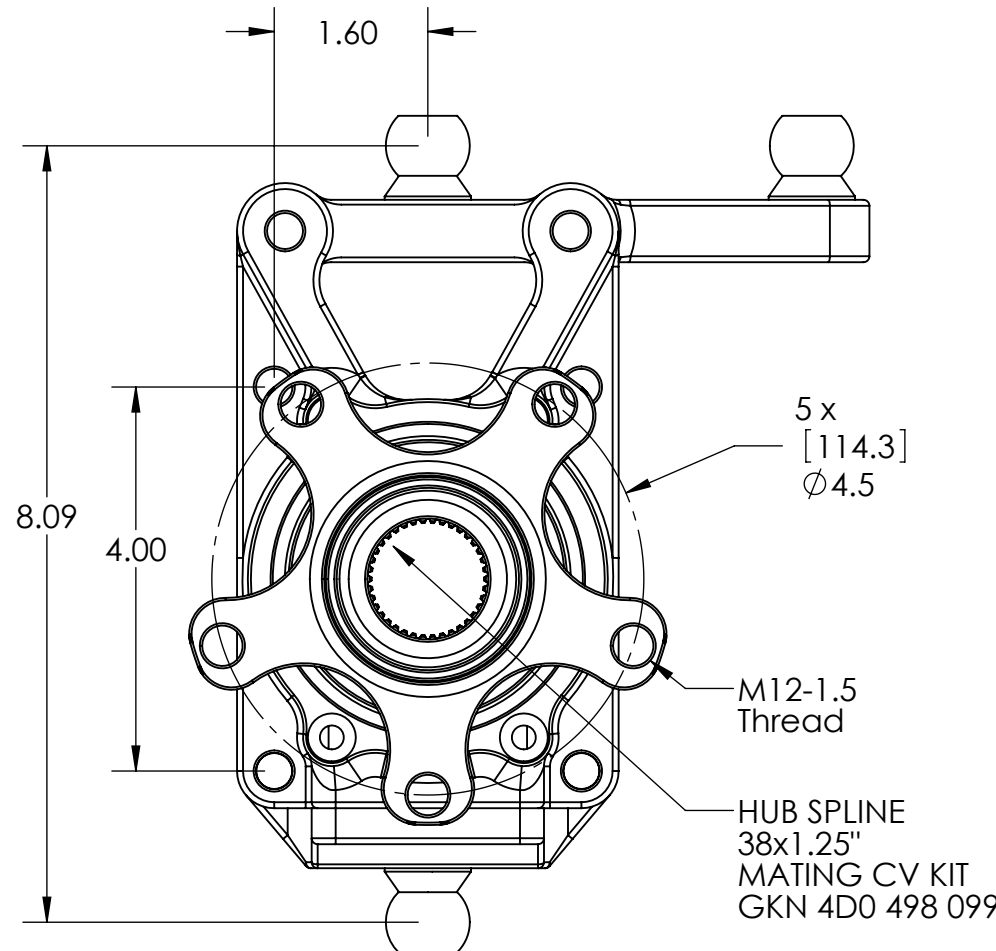
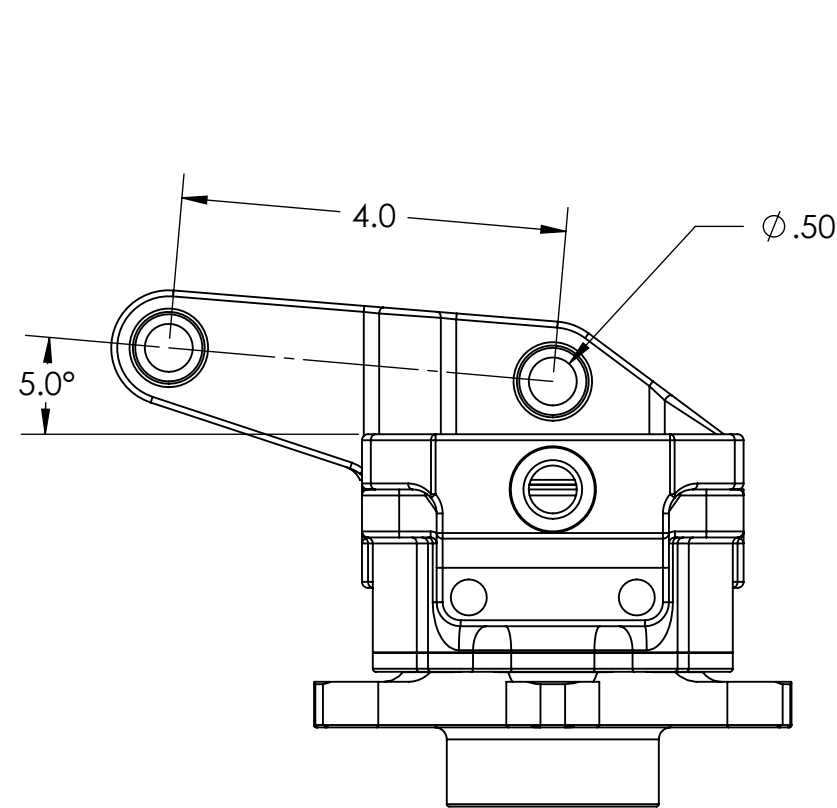

MODULAR UPRIGHT INSTALLATION DIMENSIONS
 RODEND CONFIGURATION 'B' - COMMON, FRONT/REAR, LEFT/RIGHT (STEERING ARM REVERSIBLE)
 ALL RODENDS 1/2"
 OTHER CONFIGURATIONS AVAILABLE

WEIGHT OF ASSEMBLY AS SHOWN, WITH BEARING: 7.5LBS



PROPRIETARY AND CONFIDENTIAL THE INFORMATION CONTAINED IN THIS DRAWING IS THE SOLE PROPERTY OF PALATOV MOTORSPORT LLC. ANY REPRODUCTION IN PART OR AS A WHOLE WITHOUT THE WRITTEN PERMISSION OF PALATOV MOTORSPORT LLC IS PROHIBITED. CAD FILE: C:\projects\PM Parts\upright rodend.SLDPR1	UNLESS OTHERWISE SPECIFIED:	NAME	DATE	Palatov Motorsport LLC			
	DIMENSIONS ARE IN INCHES TOLERANCES: FRACTIONAL: ± 1/16 ANGULAR: ± 1 DEG TWO PLACE DECIMAL ± .01 THREE PLACE DECIMAL ± .005	DRAWN	dp				02/01/2010
	INTERPRET GEOMETRIC TOLERANCING PER:	CHECKED			SIZE	DWG. NO.	REV
	MATERIAL Billet 6061 Alloy	ENG APPR.			B	Mod. Upright	A
	FINISH Black Anodize	MFG APPR.			SCALE: 1:2	WEIGHT: XXX	SHEET 1 OF 3
DO NOT SCALE DRAWING	Q.A.			COMMENTS:			

APPROXIMATE WEIGHT OF ASSEMBLY AS SHOWN: 19lbs

LATEST REVISION						
FUNC ID	REV	ECN	DESCRIPTION	BY	APPROV	DATE
	XXX	XXX	XXX	XXX	XXX	XXX

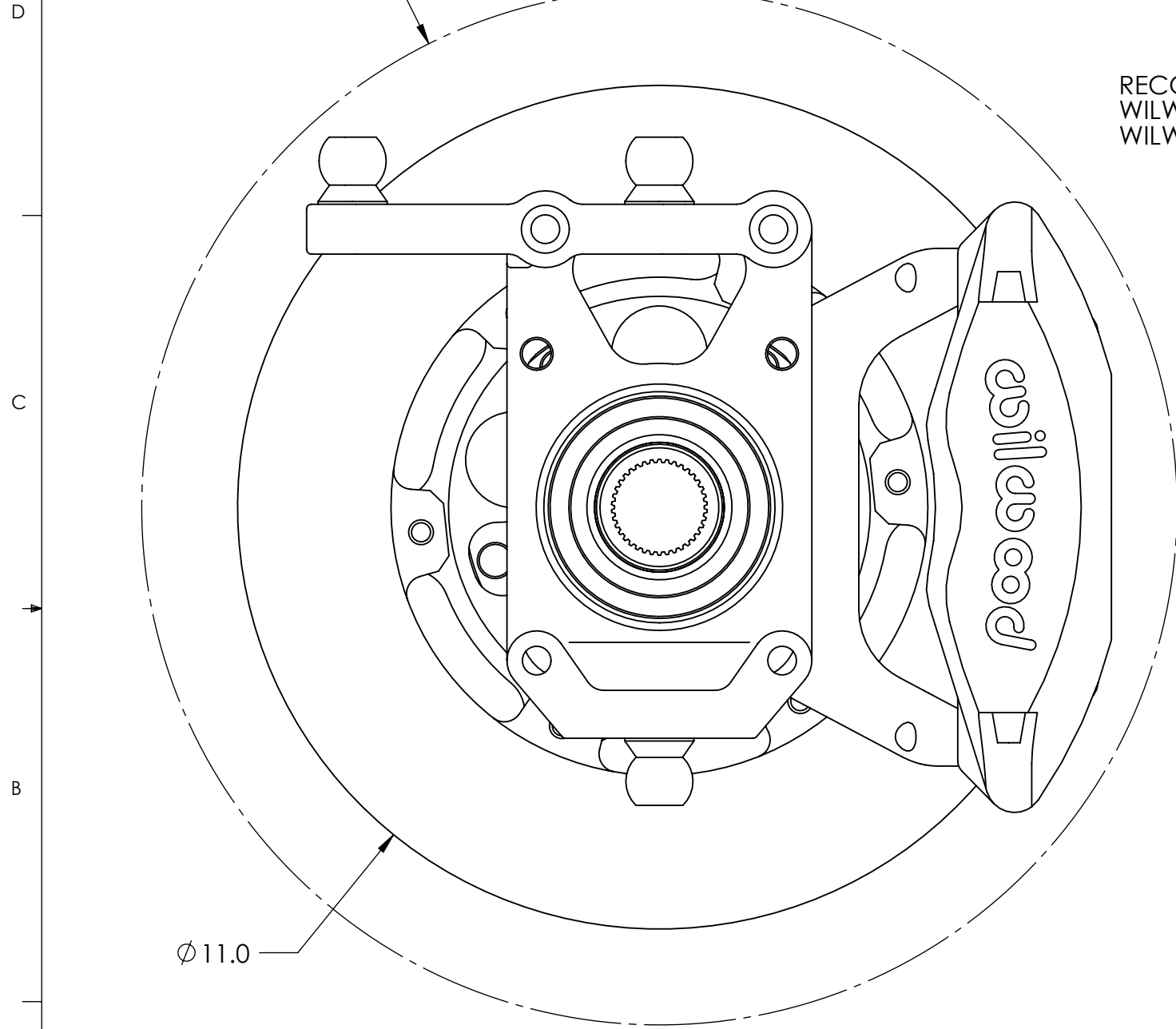

RECOMMENDED BRAKE INSTALLATION:
 WILWOOD DYNAPRO RADIAL CALIPER
 WILWOOD ULHP-30 11"X0.81" ROTOR

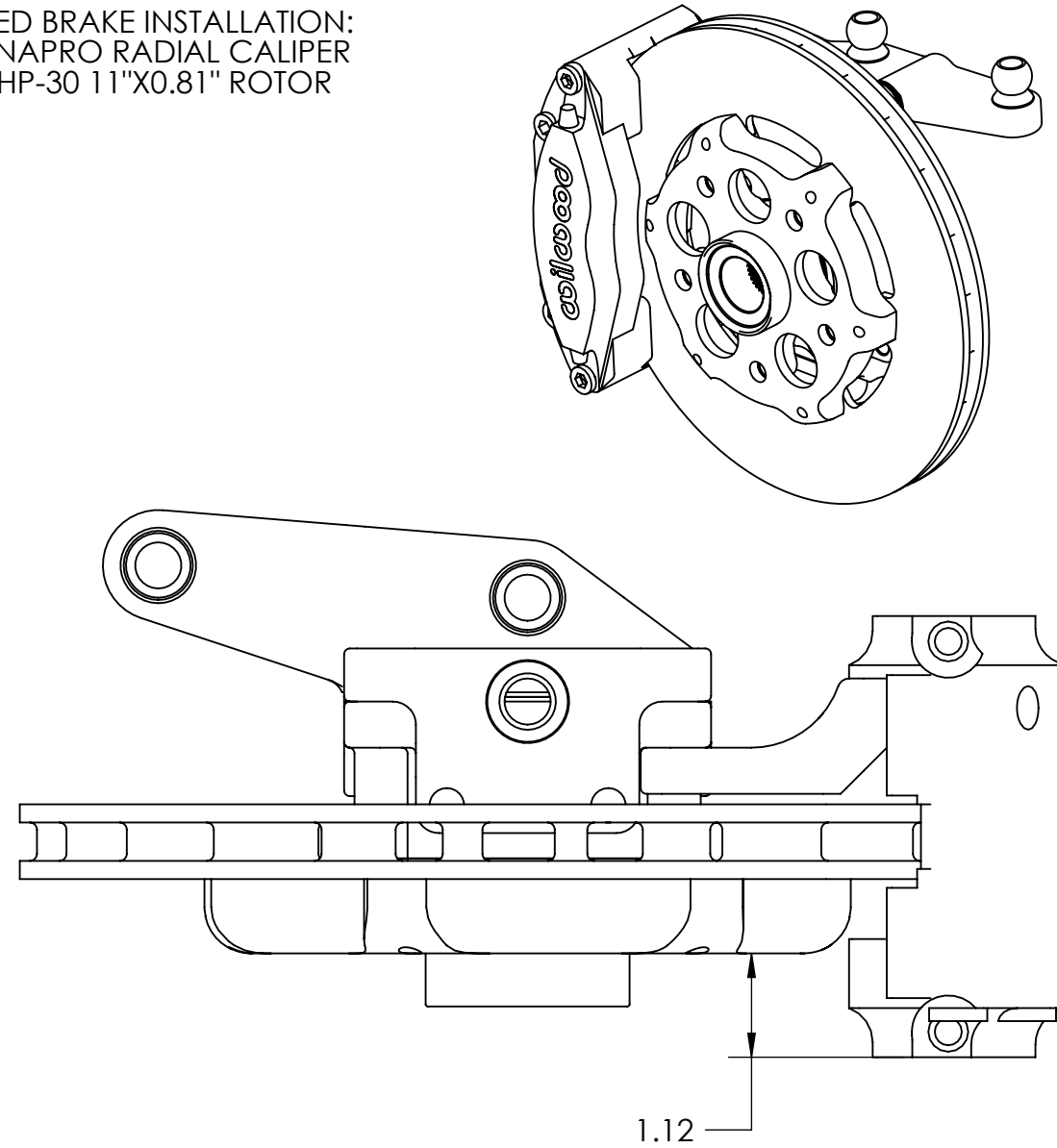

RECOMMENDED WHEEL SIZE: 15" AND LARGER



<p>PROPRIETARY AND CONFIDENTIAL THE INFORMATION CONTAINED IN THIS DRAWING IS THE SOLE PROPERTY OF PALATOV MOTORSPORT LLC. ANY REPRODUCTION IN PART OR AS A WHOLE WITHOUT THE WRITTEN PERMISSION OF PALATOV MOTORSPORT LLC IS PROHIBITED.</p> <p>CAD FILE: C:\projects\PM Parts\upright assembly.SLDPR1</p>	<p>UNLESS OTHERWISE SPECIFIED: DIMENSIONS ARE IN INCHES TOLERANCES: FRACTIONAL: ± 1/16 ANGULAR: ± 1 DEG TWO PLACE DECIMAL ± .01 THREE PLACE DECIMAL ± .005</p> <p>INTERPRET GEOMETRIC TOLERANCING PER: MATERIAL: Billet 6061 Alloy FINISH: Black Anodize DO NOT SCALE DRAWING</p>	NAME	DATE	<p>Palatov Motorsport LLC</p> <p>TITLE: Modular Upright Rodend Cfg. B 5x114.3 PCD</p> <p>SIZE: B DWG. NO.: Mod. Upright REV: A</p> <p>SCALE: 1:2 WEIGHT: XXX SHEET 2 OF 3</p>	
		DRAWN	dp		02/01/2010
		CHECKED			
		ENG APPR.			
		MFG APPR.			
		Q.A.			
		COMMENTS:			

8 7 6 5 4 3 2 1

LATEST REVISION						
FUNC ID	REV	ECN	DESCRIPTION	BY	APPROV	DATE
	XXX	XXX	XXX	XXX	XXX	XXX

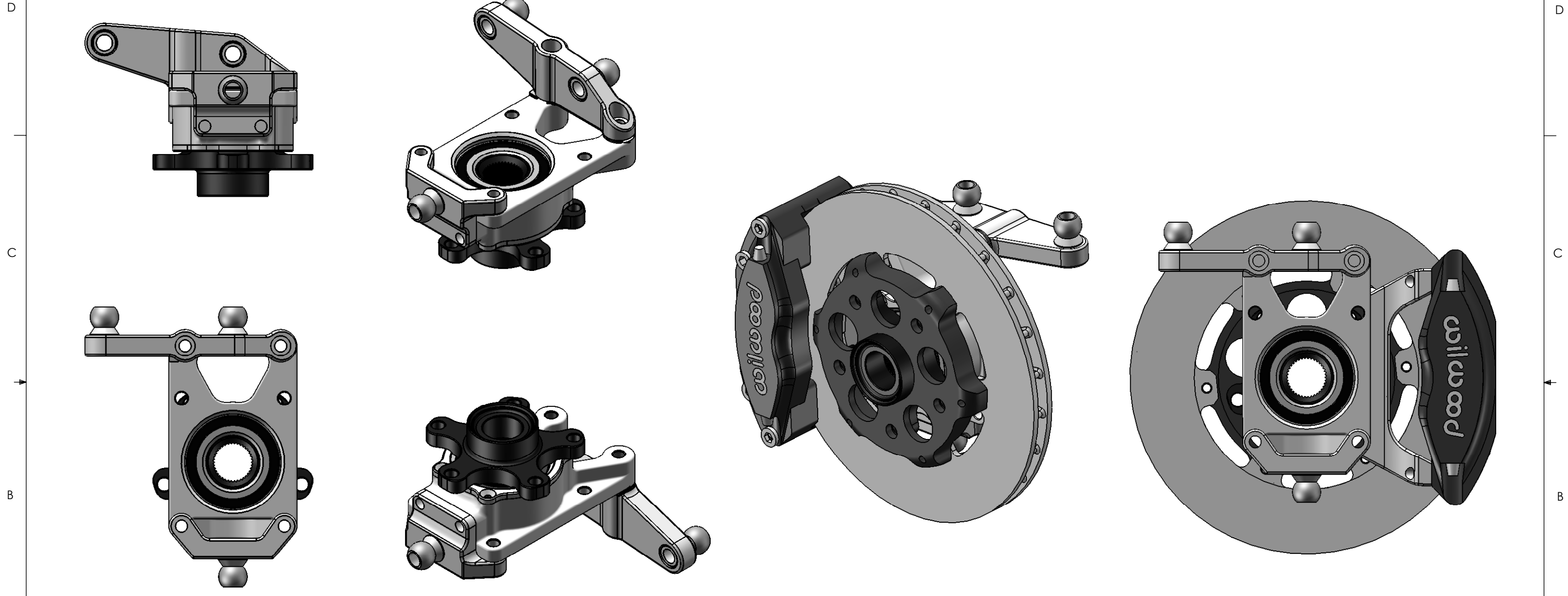

PROPRIETARY AND CONFIDENTIAL THE INFORMATION CONTAINED IN THIS DRAWING IS THE SOLE PROPERTY OF PALATOV MOTORSPORT LLC. ANY REPRODUCTION IN PART OR AS A WHOLE WITHOUT THE WRITTEN PERMISSION OF PALATOV MOTORSPORT LLC IS PROHIBITED.	UNLESS OTHERWISE SPECIFIED:		NAME: dp DATE: 02/01/2010		Palatov Motorsport LLC	
	DIMENSIONS ARE IN INCHES TOLERANCES: FRACTIONAL: ± 1/16 ANGULAR: ± 1 DEG TWO PLACE DECIMAL: ± .01 THREE PLACE DECIMAL: ± .005					
CAD FILE: C:\projects\PM Parts\upright rodend.SLDPR1	INTERPRET GEOMETRIC TOLERANCING PER:		Q.A.		TITLE: Modular Upright Rodend Cfg. B 5x114.3 PCD	
	MATERIAL: Billet 6061 Alloy		COMMENTS:			
	FINISH: Black Anodize					
DO NOT SCALE DRAWING				SIZE: B	DWG. NO.: Mod. Upright	REV: A
				SCALE: 1:2	WEIGHT: XXX	SHEET 3 OF 3

8 7 6 5 4 3 2 1